



KH SERIES KH31 & 32 FEMALE ROTARY POSITION SENSOR

The KH31/32 Series of female 2-channel rotary position sensors are designed to withstand the harsh environments of motorsport and on-vehicle automotive testing applications.

By using a proven 'Hall Effect' technology, the KH31/32 offers high performance and reliability at temperatures up to +300°F. Alternatively, it is capable of operational excellence in cold environments down to -40°F.

With a small and lightweight 0.88" diameter body and standard size flange mounting, the KH31/32 Sensor is designed for use on throttle bodies with a 0.31" D Type Shaft; other installations include: gearbox and pedal position.

The sensor is available in either Single (3 wire) or Dual (6 wire) outputs.

Sensors For Motorsport

Features

- 1 or 2 channel
- ±0.1% Linearity
- -40° to 300°F
- Lightweight - 0.7oz
- IP65 or IP67 Sealing

TECHNICAL SPECIFICATIONS

Electrical Angles (Degrees)	20° to 360° in 1° Increments. Standard Angles: 30°, 60°, 120°, 240°, 360°
Power Supply	5Vdc or 6-30Vdc (Max 32mA) Reverse Polarity Protected
Output	Please See Part Number Configurator - page 2
Output Centre Position (Voltage)	2.5V When Shaft Flat Is In Line With The Cable Exit
Resolution	12 Bit
Accuracy, Linearity	±0.1%
Accuracy, Hysteresis	<0.1°
Update Rate	5KHz
Mechanical Life	> 25 Million Cycles at Max 150RPM
Operating Temperature Range	-40°F to 300°F (-40°C to +150°C)
Housing Material	Aluminum, PEEK
Shaft Material	Aluminum
Track Technology	Hall Effect
Electrical Connection	20" 26AWG, 3/6 Wire, 55spec, FDR 25 Sleeve
Protection Class	IP65 or IP67
Weight	0.7oz (including cable)
Options	Cable Length, Electrical Angle and Labelling

Applications

- Throttle Position
- Steering Angle
- Pedal Position
- Gear Position
- Aero Surfaces
- Actuators

sales@pmc1.com
www.kasensors.com
Represented by:

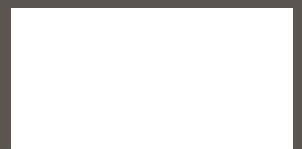

PMC/KA Sensors adopts a continuous development program which sometimes necessitates specification changes without notice

PART NUMBER CONFIGURATOR

	KH								
Series		Female Channel 1	31						
		Female Channel 2	32						
Channel 1 Range		30° (Degrees)	030						
		60° (Degrees)	060						
		120° (Degrees)	120						
		240° (Degrees)	240						
		360° (Degrees)	360						
		Insert Required Range in Place of XXX°	XXX						
Channel 2 Range		30° (Degrees)	030						
		60° (Degrees)	060						
		120° (Degrees)	120						
		240° (Degrees)	240						
		360° (Degrees)	360						
		Insert Required Range in Place of XXX°	XXX						
Supply		5Vdc		4					
		6-30Vdc		5					
Output Signal		0.5 to 4.5V (2.5V Center)			AA				
		CH1 = 0.5 to 4.5V. CH2 = 4.5 to 0.5V (Opposite)			AB				
		Custom Range, Insert Range Required			XX				
Mounting Flange Style		Flange Design C				C			
Seal Rating		IP65					65		
		IP67					67		
Shaft Style		Female D. 0.31"						DF8	
Special Codes		None							000

The KA configuration tool is used to specify a standard KA Sensor, other options are available.

MECHANICAL DETAILS

Dimensions in inches

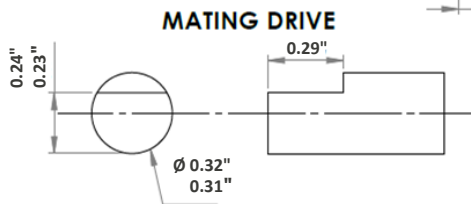
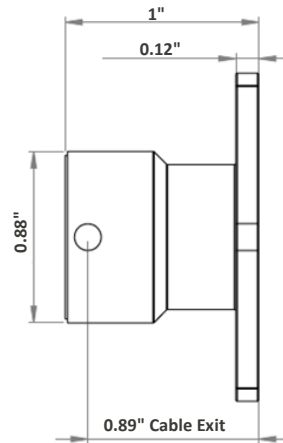
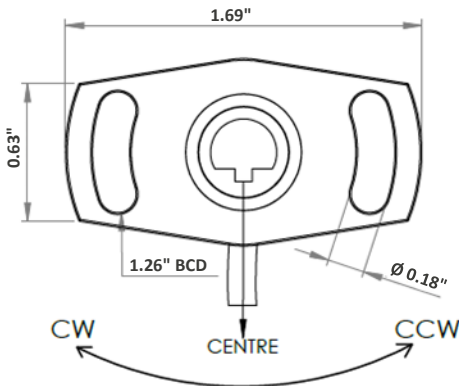

ELECTRICAL DETAILS

	+Ve Supply	0V Supply	Signal
KH31 Single Output	Red	Black	Yellow
KH32 Dual Output	Brown	Blue	White

*Sense
Analyze
Control*

Sensors For:

- Temperature
- Acceleration
- Pressure
- Position
- Torque
- Speed
- Angle
- Force

Services For:

- Data Logging
- Telemetry
- Controls
- Wiring

Contact Us

KA Sensors
Division of
PMC Engineering LLC
11 Old Sugar Hollow Rd
Danbury, CT 06810
USA

Tel: 203-792-8686

Fax: 203-743-2051

sales@pmcl.com

www.kasensors.com